

# TF1



Ball bearing slides

R72 control box



Remote control

## Specifications

Motor voltage	24 VDC
Max push force	500 N
Stroke	550/650±2mm
Installation distance	670/770±3mm
No load Current	≤2A
Max push force current	≤5A
Speed	30±10% mm/s
Color	White
Protection level	IP43
Usage frequency	10%, Maximum 2 min of continuous work
Noise level	≤50dB

## Size

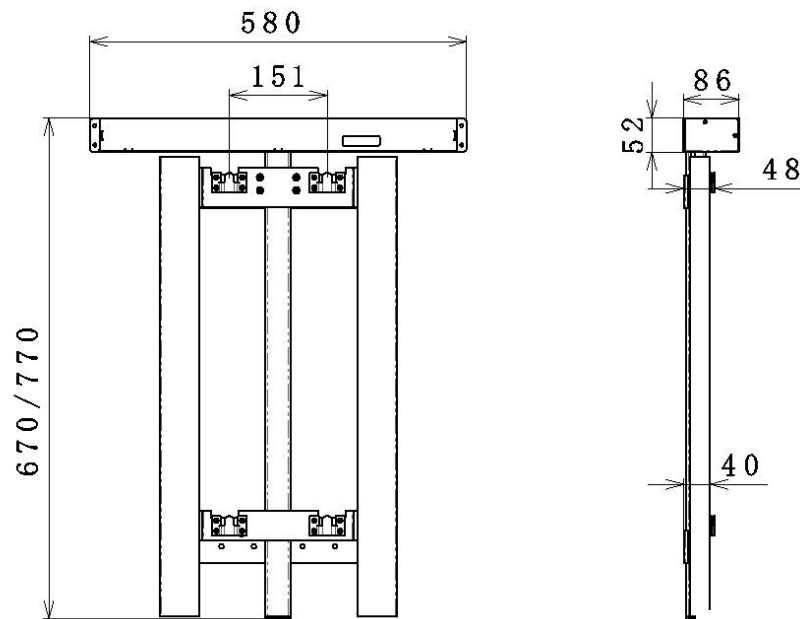

# Intelligent cabinet lifting system

## Characteristics

- 1、 Wireless remote control, intelligent automatic smooth lifting
- 2、 Random control, inductive descent to any height
- 3、 Intelligent anti-clamp, stop when encountering obstacles
- 4、 The width of the inner cabinet can be expanded freely, large bearing capacity
- 5、 2 product options

